



Welcome to HandWrite Pro

Introduction

With HandWrite Pro for Android you write with your finger or a stylus like on paper. You also can create more complex drawings.

PDF import and export lets you fill out forms, correct work, add handwritten notes to documents or images, and more.

HandWrite Pro is vector-based, so you can zoom in on your notes without losing quality.

On devices with a pressure-sensitive stylus, your drawings or handwriting will look very natural. Layers help you better organize complex documents.

→ Hold your device upright for this introduction.



→ Go to the next page now!

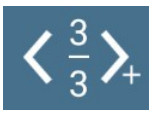

Drawing View

Since you have just opened this introduction you are in the **drawing view**. The previous view is the **document overview**, here you can select existing documents or create new ones. In the drawing view, use two-finger gestures to **zoom** ("pinch gesture") or move the screen (move fingers close together). The zoom mode „show all“  is preset.

 This document has several pages. To navigate you can use these buttons. If you are already on the last page, a page will be added when you want to go to the next page. Please note: Adding pages is not available for imported PDF documents.

 The **Burger menu** shows you options for page size, line layout, document name and tags (these are keywords for better finding and organising your documents). You can also export the document in different formats or change the global settings  here. Special pen settings for line smoothing and pen recognition are also available in this menu. You can also change the zoom factor and get information about the premium functions.



The pen menu gives you different styles to choose from:

Speed sensitive



Pressure sensitive



Normal



Marker



Fill pen



Calligraphy



Here you set the **line thickness**, have different shapes to choose from and you can also select an object or section eraser. The eraser removes either complete lines and objects or sections. It might work a bit differently than you are used to because of the vector based drawing engine. With the **selection functionality** you can draw a frame around lines or objects and then move, resize, rotate, copy, cut and delete them. You can even manipulate the individual points of the vector lines.

You can save the current pen settings to one of up to four presets  and then quickly recall them.

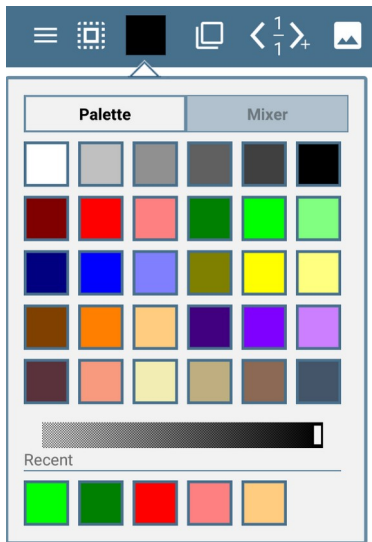

The **color selection** lets you choose between different predefined colors, but with the mixer you can create your own colors. With the transparency slider you can define translucency.

HandWrite Pro stores the last used seven colors for quick access.

You may know **layers** from professional programs like Photoshop. You can organize different content into layers, which you can edit individually. Make layers invisible and move them up and down.

You can also merge the currently selected layer with the layer below.

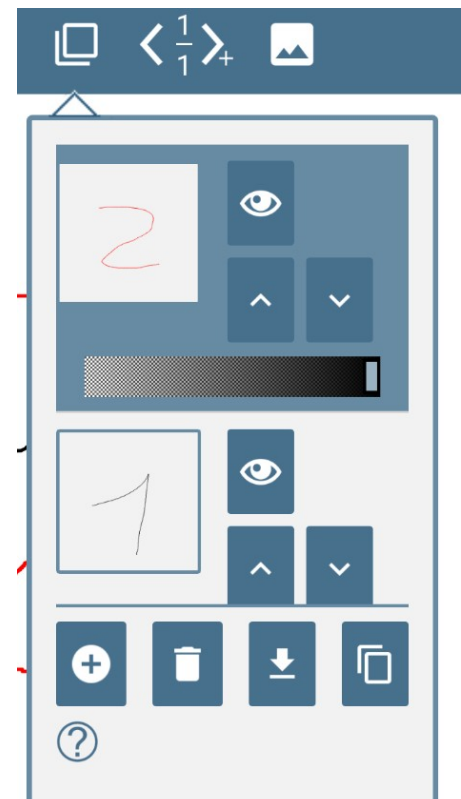



You can also add **photos** from your gallery or camera. Photos are initially selected and can be moved and resized.



The **undo** and **redo** buttons allow you to undo errors quickly.



The **full-screen** button hides most controls so that you can concentrate better on your work.

Export

After tapping on the burger menu  in the **drawing view** you can open the export area. Here you can export vector documents without quality loss as hwsbm ("HandWriteScribMaster"), PDF or SVG. Additionally, a pixel-based export as PNG, JPG or into the device gallery is available.

Please note that SVG, PNG, JPG and the gallery export only contains the current page.

Document View

The app starts in this view. Here you can open existing documents, create a new document, import PDF or SVG documents, delete or manage multiple documents.



Use the Add button to create a new, empty document or import a PDF or SVG document.



Change between ascending and descending. Sort either by date or by name.



Change **sorting** between name or date



Marker mode. If selected, documents can be selected by tapping. Selected documents can then be deleted, for example.



In the **Burger menu** you will find advanced options, e.g. you can filter documents by tags. Tags are keywords that you can give to documents in the drawing view. These keywords are more flexible than folders, because a document can be assigned to several keywords (e.g. "work" or "homework").